

READ AND FOLLOW ALL INSTRUCTIONS CAREFULLY TO ENSURE PROPER AND SAFE INSTALLATION

1. **WARNING:** Risk of fire or electrical shock.
2. **WARNING:** Disconnect power before installing or servicing.
3. **WARNING:** All wiring to be performed per National Electrical Code and local code by a qualified electrician.
4. Outdoor use only.
5. Suitable for Wet Location covered canopy.
6. Non-combustable surfaces only.

Fixture Wiring

1. Fixture is equipped with a hanging tie strap to suspend fixture during installation. A small nail or screw can be installed in ceiling if no hanging point is available.
2. Remove four (4) screws from wiring compartment and remove cover (FIG A).
3. Remove knockout and make conduit connection to cover.
4. Connect supply wires to fixture using appropriate wire nuts (FIG B).
 - 1.2. Connect ground wires to fixture ground (green).
 - 1.3. Connect AC common wire to fixture common (white).
 - 1.4. Connect AC line wire to fixture(s) common (black).

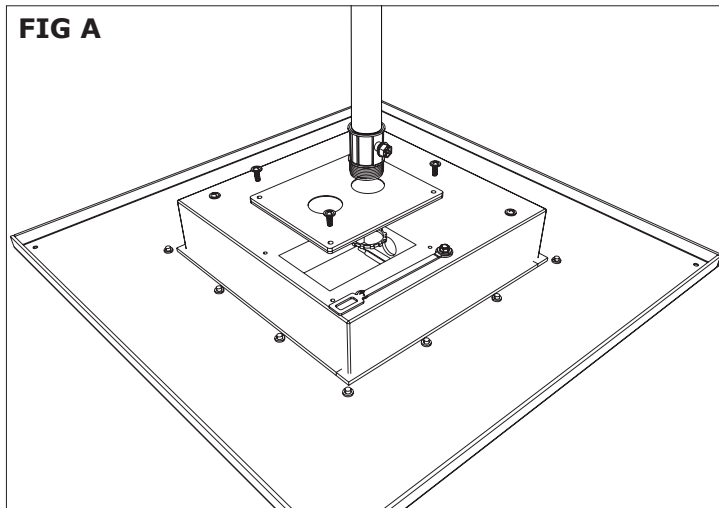

5. After making connections, replace fixture cover and secure with provided screws. **NOTE: Be sure cover fits properly and there is no interference with wiring.**

Dimming Controls

This luminaire supports 0-10V dimming (control supplied by others) via the yellow (10V), purple (0-10V) or gray (neg) wires on the output side of the driver. Follow specific dimming control instructions for proper wiring.

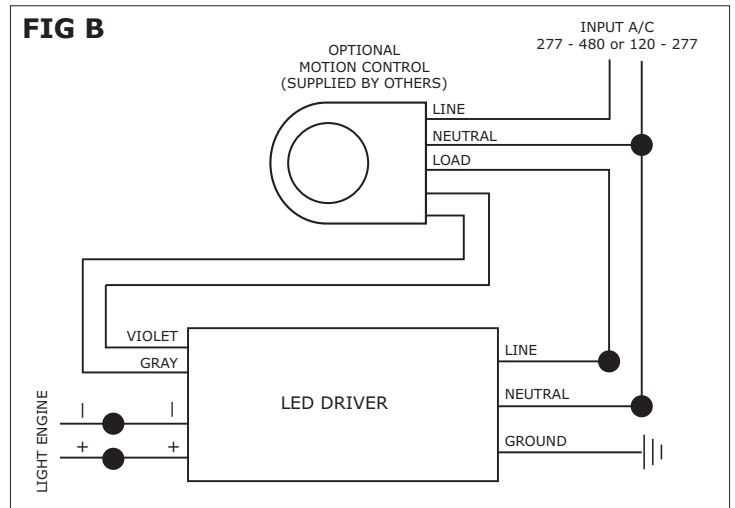

Fixture Mounting

1. To mount recessed fixture, cut round or square access hole in ceiling large enough to fit back box (FIG C).
2. Securely mount fixture to ceiling using four (4) supplied screws and necessary anchors (supplied by installer).

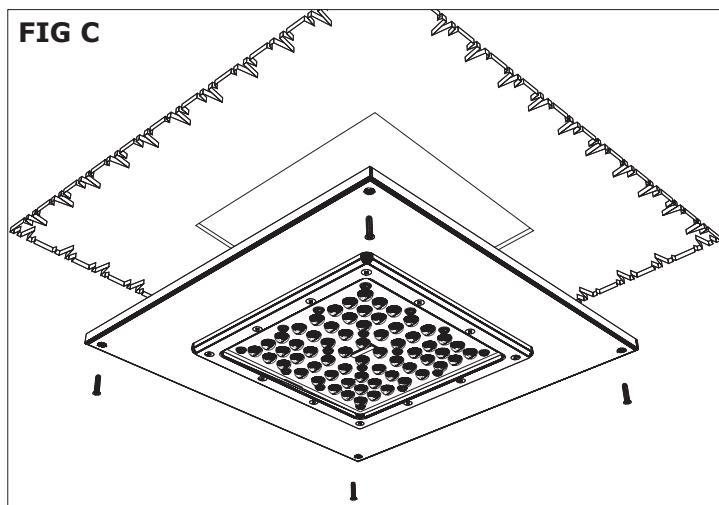

NOTE: Outer fixture dimensions can be custom ordered to fit alternate sized openings as small as 12" x 12".

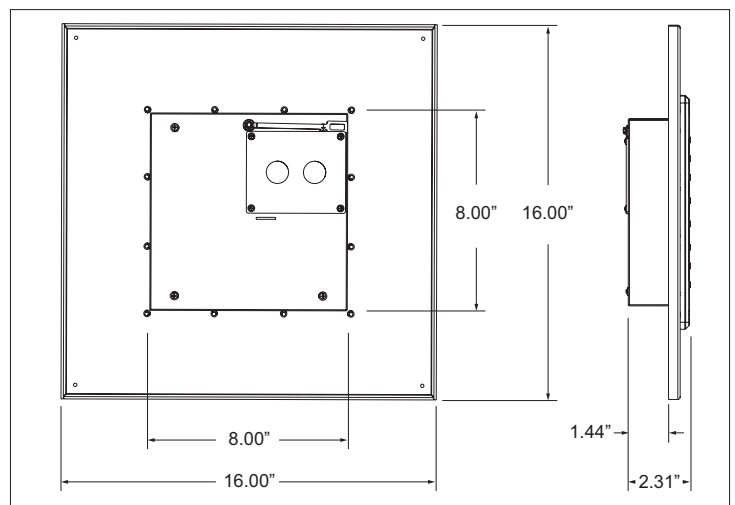

Remote Mounted Battery Backup (RBB)

1. Fixtures ordered with Remote Battery Backup option are prewired from factory and come complete with 12' cable for operation with remote battery backup.
2. Refer to detailed battery backup installation guide for further details.

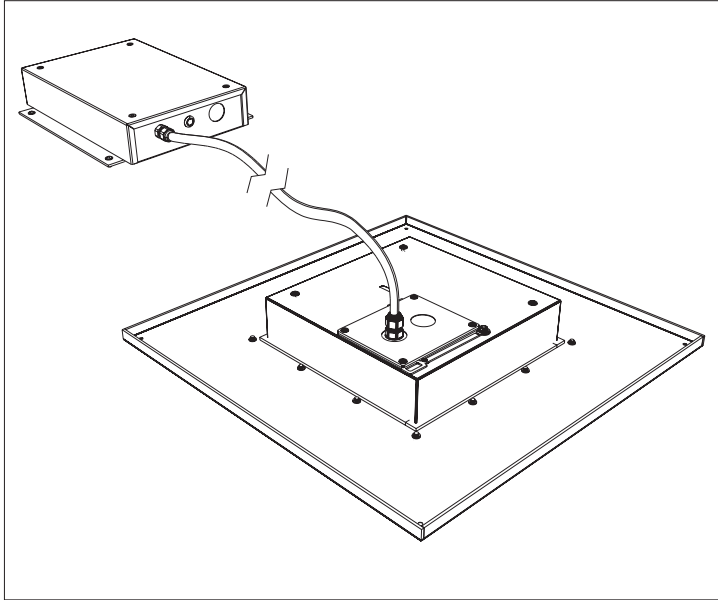

Surface Mount Conversion (RCS16-XX)

1. Mount recessed fixture using optional surface mount conversion plate (ordered separately) .
2. Use (4) 3" bolts to mount fixture and plate to ceiling.

